

# Tunnel Shutters Part Numbers

## Parts List

- A) Qty 1 Top Shutter with flap seal
- B) Qty 3 Shutter
- C) Qty 6 Spacer
- D) Qty 2 Top Coupler
- E) Qty 1 Top Rail
- F) Qty 2 Vertical Rail
- G) Qty 1 Bottom Rail
- H) Qty 2 Bottom Coupler
- I) Qty 1 Tie Bar
- J) Qty 1 Track
- K) Qty 1 Pin/In
- L) Qty 1 Pipe
- M) Qty 1 Pipe Support
- N) Qty 1 HD Bracket
- O) Qty 4 Lag Bolt
- P) Qty 6 Wood Screw
- Q) Qty 4 #10 Machine Screw and Nut
- R) Qty 2 Rebar Strip
- S) Qty 6 Christmas Tree Rivet
- T) Qty 1 1/4-20 Bolt and Nut

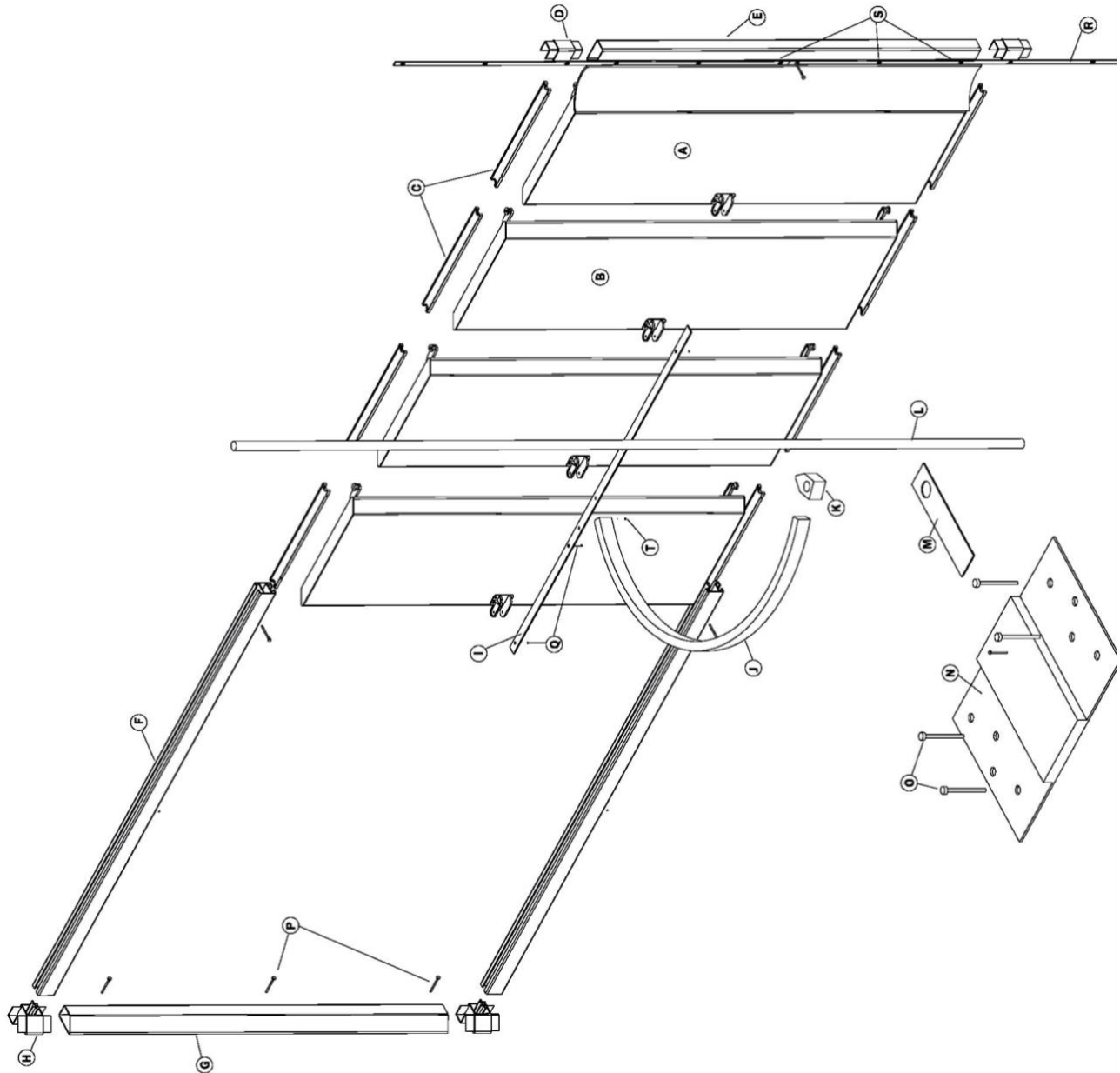

**A**

6120048 Stainless Steel Shutter Panel with Top Seal

**B**

6120039K Individual Shutter Kit

6120047 Stainless Steel Shutter Panel

**C**

6120037 Regular Shutter Spacer

6120031 Top spacer (Short)

**D**

6120008 Top Coupler Vertical Rail

**E & G**

6120029 Horizontal Rail

**F**

6120015 Vertical Rail 4 ft

6120002 Vertical Rail 5 ft

6120011 Vertical Rail 6 ft

**H**

6120009 Bottom Coupler Vertical Rail

**I**

6120034 Tie Bar 4'

6120026 Tie Bar 5'

6120035 Tie Bar 6'

**J**

6120027 Rack

**K**

6120028 Pinion

**M & N**

6120004 Pipe Bracket Doghouse

**R**

6120032 Top Retainer Strip

**T**

6120025 Tie Bar Bracket

**U**

6120023 Shutter Hinge Left

**V**

6120024 Shutter Hinge Right

## ADDITIONAL PARTS

6120030	Top Seal
6120021	Shutter End Cap
6120003K	Pipe Kit (19.5 ft with bolt)
6120012K	Universal Joint Kit
6120005	Pipe Bracket Hanging – Ext 5’&6’
6120019	Pipe Bracket Hanging – Ext 4’
6100010	Gear Plate- Wall Mount – Tunnel